

POT BEARING HOUSING ASSEMBLIES FOR VOLKMANN MANUAL & AIR THREADED POTS 07-08 BA4 REBUILD & EXCHANGE SERVICE

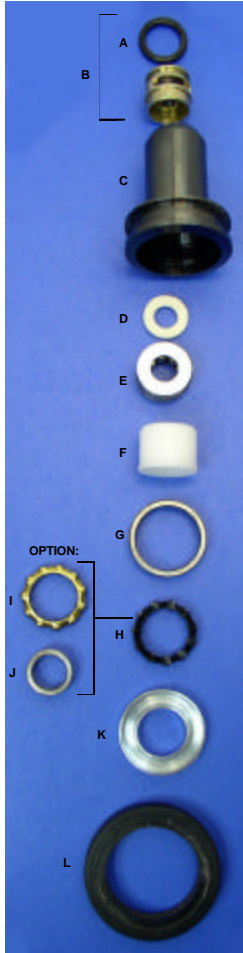

REBUILDING POT BEARING HOUSINGS: The used assembly is disassembled, cleaned and inspected. Epic **always** replaces the felt sealing washer (D), upper needle bearing (E), nylon spacer bushing (F), lower outer race (G), and bearing cage (customer to specify polyamide (H) or brass (I)). Any static parts that show wear or faults are also replaced. The rebuilt assembly is lubricated with Kluber synthetic grease.

The rebuilt pot bearing housings function “like new”, at a significant savings to the customer.

Because it is good practice to replace the inner race (J) on the upper spindle blade when replacing the bearing cage, polyamide (H) or brass (I), a new inner race (J) is also supplied with the exchange or rebuilt assembly when the brass bearing cage is used.

- (A) EE435058: O-Ring, 15x3
- (B) EE481183: Complete Injector
- (C) EE481180: Steel Shell
- (D) EE481185: Top Felt Washer
- (E) EE402002: Needle Bearing
- (F) EE481182: Nylon Bushing
- (G) EE401902: Outer Race, E-13
- (H) EE401903-1: Polyamide Bearing Cage, E-13
- (I) EE401903: Brass Bearing Cage, E-13
- (J) EE401904: Inner Race, E-13
- (K) EE481181: Labyrinth Ring
- (L) EE480979: Rubber Damping Protection Ring

OEM #	Epic #	Description
170522 237008 259259 267203 283903	EE402022	Complete NEW Pot Bearing Housing, with inner race
(170522)	EE402139	REBUILD Customer's Complete Pot Bearing Housing
(237008)	EE402139-1	USED & REBUILT Complete Pot Bearing Housing, for Exchange
(259259)		
(267203)		
(283903)	EE402139-2	REBUILT FOR SALE, Complete Pot Bearing Housing, Rebuilt

November 11, 2003

Epic Enterprises, Inc., PO Box 979, Southern Pines, NC 28388-0979 USA
Telephone 800-648-7273 or 910-692-5441 Outside USA
Fax 888-692-4147 or 910-692-4147 Outside USA
Website: <http://www.epicenterprises.com>
E-mail: epic@epicenterprises.com

